



3102KL-AM Heavy Duty Antimicrobial Platform Scale



USER INSTRUCTIONS

**ISO13485:2003
CERTIFIED**



PELSTAR, LLC 9500 West 55th St. McCook, IL 60525-7110 USA

www.homscales.com

© Pelstar, LLC 2016

P/N UM3102KL-AM Rev20161108

Thank you for your purchase of this Health o meter® Professional product. Please read this manual carefully, and keep it for easy reference or training.

TABLE OF CONTENTS

Cautions and Warnings	3
Specifications	4
Set Up Instructions	5
Operating Instructions	7
Maintenance.....	10
Troubleshooting.....	13
Calibration	14
Warranty.....	15

Note: This scale has been factory calibrated, and does not require calibration prior to use.

CAUTIONS AND WARNINGS

- The weight of this scale is substantial as it is designed for heavy-duty use in a clinical environment. Use care when using or moving this device.
- To prevent injury and damage to your scale, please follow these instructions very carefully.
- Operate the scale per the enclosed user instructions.
- For accurate weighing, this scale must be placed on a flat, stable surface.
- For accurate weighing, verify before each use the proper operation according to the procedure described in this manual.
- Operating this scale at voltages and frequencies other than specified can damage the equipment and will void the warranty.
- Do not transport the scale with anything on the platform.
- Do not exceed recommended weight limit of 1000 lb / 454 kg for this scale.
- Do not use in the presence of flammable or explosive materials.
- For accurate weighing, if the display indicates that the batteries are low, replace the batteries or switch to the optional AC adapter as soon as possible.
- If the scale becomes damaged, it should not be operated until properly serviced.
- When replacing / inserting batteries, be sure to use all new batteries.
- To prevent patient injury, the patient must be attended throughout the entire weighing event.

When operating this scale with the optional AC adapter:

- Operate this scale exclusively with the AC adapter supplied by Health o meter Professional scales, AC adapter model ADPT50. Use of an unspecified adapter will void the warranty, and can pose a serious safety hazard.
- Prior to using this scale, inspect the AC adapter cord for cracking / fraying, and for broken / bent plug prongs.
- Prior to using this scale, ensure that the AC adapter is plugged into an outlet with the rated voltage appropriate for operation.
- Ensure that the AC adapter outlet is wired to a circuit breaker or other protected power source.
- Ensure that the AC adapter and scale do not come in contact with liquids, excessive temperature, or excessive humidity.
- If the scale is being connected to another medical device, the power adapter must not be used. Disconnect the power adapter from the scale and use only the battery power. This ensures proper electrical isolation.

SPECIFICATIONS

General

Health o meter® Professional model 3102KL-AM uses sophisticated microprocessor technology. This precision instrument is designed to provide accurate, reliable and repeatable weight measurements and features that make the weighing process simple, fast and convenient.

Although the patient's weight can be displayed in either pounds (LB) or kilograms (KG), the scale can be "locked" into KG mode. See the instructions on page 8 to lock the weight measuring unit.

This scale is set up to use motion-sensing weighing technology in order to determine the weight of a moving patient. **This scale can be powered using an AC adapter, ADPT50 (included), or by 6 D-cell batteries (included).**

Antimicrobial Powder Coating

Unique to the 3102KL-AM scale, the handrails, transport handle and all other painted surfaces have been fabricated with a permanent, antimicrobial powder coating. The antimicrobial coating utilizes silver ionic technology to inhibit the growth of microbes.

Capacity and Resolution:	1000 lb x 0.2 lb (454 kg x 0.1 kg)
Power Requirements:	110-240V AC – 6V DC 50-60Hz, Adapter Model ADPT50 (included), or 6 D-cell batteries (included)
Environmental:	Operating Temperature: 50°F to 104°F / 10°C to 40° C Storage Temperature: 30°F to 125°F (-1°C to +52°C) Maximum Humidity: 85% RH in use or in storage



***WARNING:**

For use with AC Adapter Model ADPT50 or with 6 D-cell batteries.

Equipment is not suitable for use in the presence of flammable anesthetic mixture with air or with oxygen or nitrous oxide.

Certifications

	Pelstar, LLC has been officially certified as the manufacturer of Health o meter® Professional medical devices. The Pelstar, LLC quality assurance system covers the development, production, sales and service of medical scales and measuring systems.
---	--

SET UP INSTRUCTIONS

Parts List

- 3102KL-AM Scale, Fully Assembled
- User Instructions (located in enclosed envelope)
- Quick Reference Guide (located in enclosed envelope)
- (6) D-cell Batteries (located in brown box inside packaging)
- (1) AC Power Adapter (ADPT50)
- (1) T30 Torx Head Wrench
- (2) ¼ 250V Amp Fuse (for replacement use if needed)

Warning: To avoid damaging the load cells, do not drop the scale.

Powering the Scale

1. Plug the AC adapter into the power adapter jack (the jack is located on the rear of the column), then plug the scale's AC adapter into the power source.

Warning: To avoid a safety hazard, do not use an unspecified AC adapter. Only use the Health o meter[®] Professional AC adapter model ADPT50 designed for this scale.

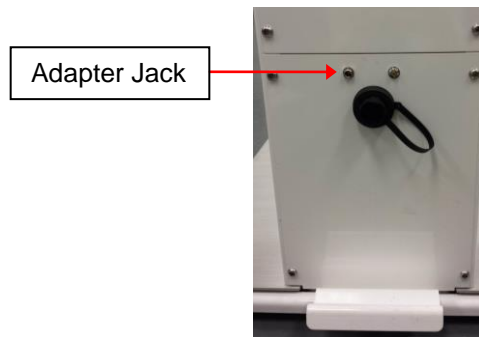

2. For battery operation, see Battery Installation below.

Battery Installation

Caution: If the AC adapter is connected, unplug it from the power source before installing or replacing the batteries.

1. The battery compartment is located behind the protective metal plate on the back of the scale. Using the included T30 Torx head wrench, remove the four screws securing the metal plate. Start with the bottom two screws, holding the plate in place as you remove the remaining screws. After all screws are removed, carefully set the metal plate and screws aside.

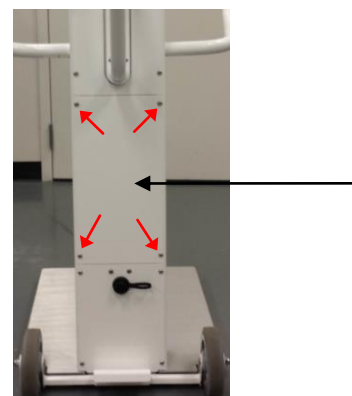

3102KL-AM SET UP INSTRUCTIONS (continued)

2. Remove the battery compartment cover by unscrewing the 4 thumb screws. Note: Take care not to drop the thumb screws into the scale mechanism.

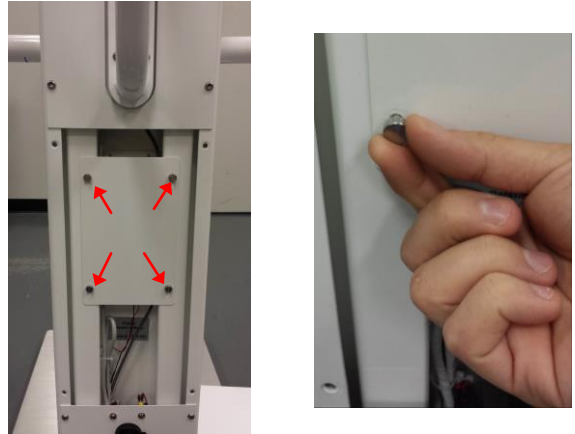

3. Install 6 D-cell batteries following the +- illustrations on the compartment. Do not use zinc-carbon batteries.



4. Place the battery cover on by reattaching the 4 thumb screws.

5. Place the protective metal plate onto the back of the pillar by reattaching the four screws, starting with the top two screws.

Warning: If the scale will not be used for some time, remove all batteries to avoid a safety hazard. Disposal of batteries should be done according to the national, regional or local regulations.

Note: To preserve battery power, this scale will automatically power off after 5 minutes of inactivity.



OPERATING INSTRUCTIONS



Using the Keypad

KEY	FUNCTION
ENTER	Used during calibration procedure
	Powers scale ON and OFF.
REWEIGH	Allows repeated weighing of patient without stepping off the scale.
HOLD	Holds the value of the weight measurement on the display until the button is pressed again to clear the value.
RECALL	Recalls the previous weight until the button is pressed again to clear the value.
ZERO	Zeros the scale prior to weighing.
LB/KG	Allows user to change weight measuring unit.

Weighing a Patient

1. Make sure there is nothing on the weighing platform.
2. Press the  button to turn on the scale.
3. Wait until '0.0' and 'Zero' appear on the display. If the scale has been moved it may be necessary to press the **ZERO** button to clear the display.
4. Ask the patient to step on the scale. The scale will begin to display the patient's weight and will lock on the patient's weight when completed. Depending on the movement of the patient on the scale, it may take several seconds for the scale to lock onto the weight.
5. The weight will change until the patient weight is captured. The scale will beep three times and the word "Lock" will appear on the display.
6. The weight may be held on the display by pressing the **HOLD** button. To release, press the **HOLD** button again.
7. After recording the weight, have the patient step off the scale.
8. Press the  button to power the scale off.

OPERATING INSTRUCTIONS (CONT.)

Holding a Weight Value

Once a patient's weight has been determined, the weight value can be held while assisting the patient off of the scale. To hold the weight value, press the **HOLD** button while the patient remains on the scale. To clear the weight value, press the **HOLD** button again.

Weight Recall

The last weight reading on the scale can be recalled by pressing the **RECALL** button. To clear the display of the recalled weight, press the **RECALL** button again.

Note: Clearing the recalled weight from the display will not clear the recalled weight from memory. The recalled weight will remain in memory until another weight is obtained.

Reweigh

To reweigh the patient without the patient stepping off of the scale, press the **REWEIGH** button.

To Change Weight Measuring Unit (LB to KG/KG to LB):

Note: LB (Pounds) is the default weight measuring unit upon initial set-up/assembly. Unit of measure is displayed in the lower right corner of the display and shown as lb or kg.

1. Press the  button to turn the scale on.
2. Wait for "0.0" LB or "0.0" KG to appear on the display.
3. Press the LB/KG button until the desired unit of measure is displayed.
4. Release the LB/KG button and the scale will operate in the selected mode.
5. Repeat steps 3-4 to change the weighing mode to a different unit of measure.

Locking the Weight Measuring Unit to KG Only

Caution: Please make sure you carefully and precisely follow the directions below as you will be in the PROGRAM MODE of your scale. Any modification outside of what is listed below may greatly affect the functionality of your scale.

1. Press the  button to power on the scale. As soon as you turn on the scale, press the **REWEIGH** button once, the **ZERO** button twice, and then the **REWEIGH** button once again. The scale will display "CAL".
2. Press the **REWEIGH** button twice and "PROG" will show on the display.
3. Press the **ENTER** button and OP1-0 will be displayed.
4. Press the **REWEIGH** button once and the display will read "OP2-0" for the KG lock function, To enable the KG lock, press the **ZERO** button so the display reads "OP2-1".
5. Press the **ENTER** button, the scale will read "START", then read "0.0 Kg"
You have successfully locked your scale into KG Only.

OPERATING INSTRUCTIONS (CONT.)

Deactivating the KG Only Lock

1. Press the  button to power on the scale. As soon as you turn on the scale, press the **REWEIGH** button once, the **ZERO** button twice, and then the **REWEIGH** button once again. The scale will display “CAL”.
 2. Press the **REWEIGH** button twice and “PROG” will be displayed.
 3. Press the **ENTER** button and OP1-0 will be displayed.
 4. Press the **REWEIGH** button once and the display will read “OP2-1” for the KG lock function. To disable the KG lock press the **ZERO** button so the display reads “OP2-0”.
 5. Press the **REWEIGH** button (7 times) until display reads “DONE”
 6. Press the **ENTER** button, the scale will read “START”, then read “0.0”
- You have successfully deactivated the KG lock on your scale.*

Moving the Scale

The 3102KL-AM was designed with a convenient transport handle that allows users to easily move the scale throughout their facility. The rugged, scuff-proof wheels ensure smooth movement and enhanced portability. When moving the scale:

1. Place foot on the kickplate located on the bottom rear of the pillar.
2. Push downwards on the kickplate and pull backwards on the transport handle to tip the scale onto its wheels.
3. Push or pull the scale to its desired location.
4. Gently lower the scale’s platform onto the floor to avoid damaging the load cells.

Connectivity Information

To enable reliable transmission of weight, height, and Body Mass Index (BMI) data, this scale is designed to connect to a computer, monitor, or other electronic device via a built-in USB port. The USB port is located behind the black plastic cover towards the bottom of the pillar. To access the USB port, unscrew the cover by turning it counterclockwise.

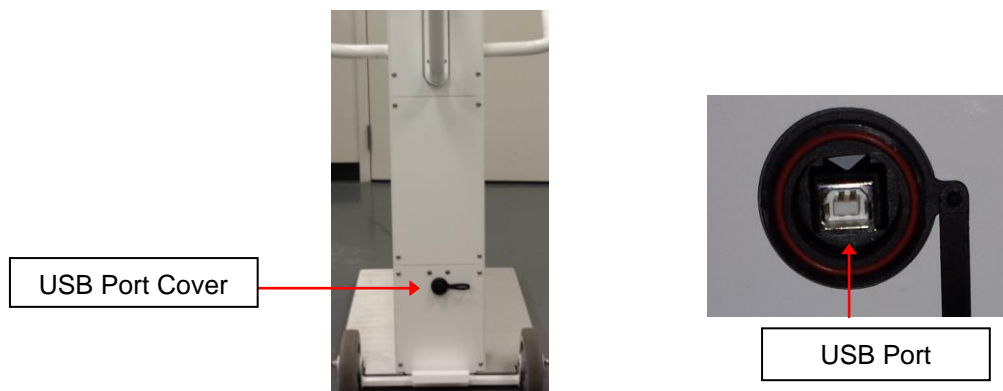

For more information regarding how to connect this scale to other electronic devices, please contact Health o meter[®] Professional Scales Technical Support at 1-800-638-3722.

MAINTENANCE

General

This section provides instructions for maintenance, cleaning, and troubleshooting the 3102KL-AM. Maintenance operations other than those described in this section should be performed by qualified service personnel such as Biomed or Engineering.

1. This scale contains electronic parts. Use it carefully. Do not drop, kick or jump on it.
2. Do not store near chemicals, heaters or radiators.
3. Do not store the scale on its side.

Before first use and after periods of non-use, check the scale for proper operation. If the scale does not operate correctly, refer to qualified service personnel such as Biomed or Engineering. For additional questions contact Health o meter Professional Scales Customer Service at 1-800-815-6615.

1. Check overall appearance of the scale for any obvious damage, abuse, etc.
2. Inspect condition of AC adapter cord and prongs, replace if needed.

Replacing the Fuse

Should your scale experience an influx of excessive electric current, the fuse may need to be replaced.

Caution: If the AC adapter is connected, unplug it from the power source before replacing the fuse.

1. Using the included T30 Torx head wrench, remove the 4 screws to detach the middle metal plate on the back of the pillar.

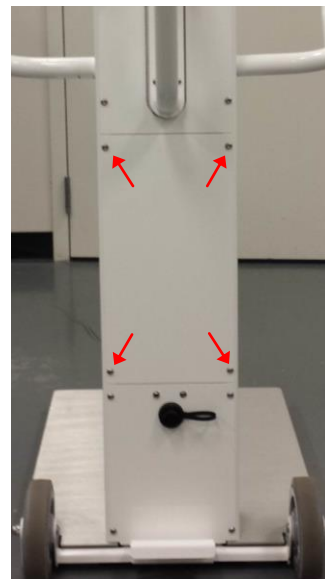

MAINTENANCE (CONT.)

2. Locate the black fuse holder and carefully unsnap it open.

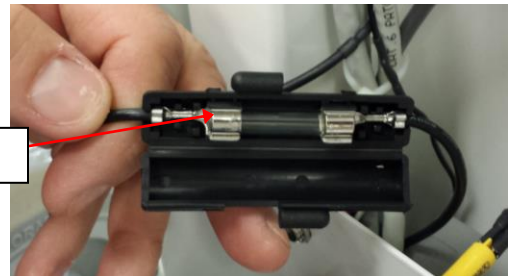

3. Gently lift the wire out of the fuse holder and remove the fuse from the terminal.

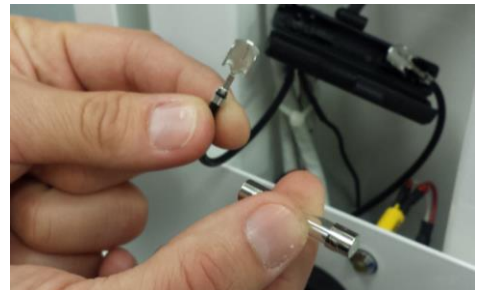

4. Insert the new fuse into the terminal. Gently place the fuse and wire back into the fuse holder while placing the other end of the fuse into the remaining terminal.



MAINTENANCE (CONT.)

5. Place the fuse and wire back into the fuse holder and snap the holder closed. Position the fuse holder back inside the pillar. Reattach the metal plates onto the back of the pillar.

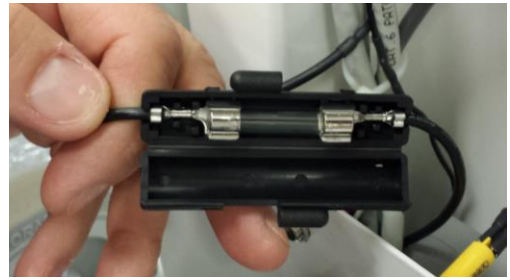

CLEANING

Proper care and cleaning is essential to ensure a long life of accurate and effective weighing.

Caution: Disconnect the scale from the AC adapter power source prior to cleaning the unit.

Note: Routine cleaning does not affect the antimicrobial properties of the handrail coating.

1. Clean all external surfaces with a clean damp cloth. Mild antimicrobial or antibacterial soap and water solution may be used. Dry with a clean soft cloth.
2. Do not immerse the scale in cleaning or other liquid solutions.
3. Do not use Isopropyl Alcohol or other solutions to clean the display surface.
4. Do not use abrasive cleaners.

TROUBLESHOOTING

Refer to the following instructions to check and correct any failure before contacting Customer Service at 1-800-815-6615.

SYMPTOM	POSSIBLE CAUSE	CORRECTIVE ACTION
Scale does not turn on	<ol style="list-style-type: none"> 1. Dead battery 2. Faulty electrical outlet 3. Bad power supply 4. Blown fuse. 	<ol style="list-style-type: none"> 1. Replace batteries 2. Use a different outlet 3. Check LED light at the bottom rear of the pillar to determine if adapter cord is working. If the light is not illuminated the adapter may need to be replaced. 4. If your scale experienced an influx of excessive electric current, the fuse may need to be replaced. See page 10 for fuse replacement instructions.
Questionable weight or the scale does not zero	<ol style="list-style-type: none"> 1. External object interfering with the scale 2. The display did not show '0.0' before weighing 3. Scale is not placed on a level floor 4. Scale is out of calibration 	<ol style="list-style-type: none"> 1. Remove interfering object from the scale 2. Assist the patient off the scale, zero the display and begin weighing process again. 3. Place the scale on a level floor and begin weighing process again 4. Check weight with known weight value
The display shows "OVER"	The load on the scale exceeds the capacity (1000 lb/454 kg)	Remove the excess weight and use the scale according to its design rating.
The display indicates that the batteries are low	The batteries are depleted	Replace batteries according to instructions

CALIBRATION

This scale is factory calibrated and does not require calibration prior to use.

The calibration procedure should be performed using a known / certified weight in pounds. The 3102KL-AM requires 300 pounds for calibration. If you prefer to calibrate in kilograms, please call Customer Service at 1-800-815-6615.

ACTION	DISPLAY SHOWS
Press the  button to turn on the scale and while “START” is displayed, press REWEIGH - ZERO - ZERO - REWEIGH	“CAL”
Press ENTER to start the calibration procedure.	“Load/300.0”
Load 300lb onto the scale platform, then press ENTER .	“CLEAR”
After “CLEAR” appears on the display, remove the weight from the platform, then press ENTER . The scale will then calibrate zero.	“-----”
When zero calibration is complete, the display will ask for 300lb weight again.	“PUT/300.0”
Load 300lb onto the platform, then press ENTER .	“DONE”/“CLEAR”
After “CLEAR” appears on the display, remove the weight from the platform and the scale will reboot.	“-----”
Scale is ready for normal operation after reboot and the display returns to “0.0”.	“0.0”

WARRANTY

Limited Warranty

What does the Warranty Cover?

This Health o meter® Professional scale is warranted from date of purchase against defects of materials or in workmanship for a period of two (2) years. If product fails to function properly, return the product, freight prepaid and properly packed to Pelstar, LLC (see “To Get Warranty Service”, below, for instructions). If the manufacturer determines that a defect of material or in workmanship exists, the customer’s sole remedy will be replacement of the scale at no charge. Replacement will be made with a new or remanufactured product or component. If the product is no longer available, replacement may be made with a similar product of equal or greater value. All replaced parts are covered only for the original warranty period.

Who is Covered?

The original purchaser of the product must have proof of purchase to receive warranty service. Please save your invoice or receipt. Pelstar dealers or retail stores selling Pelstar products do not have the right to alter, or modify or any way change the terms and conditions of this warranty.

What is Excluded?

Your warranty does not cover normal wear of parts or damage resulting from any of the following: negligent use or misuse of the product, use on improper voltage or current, use contrary to the operating instructions, abuse including tampering, damage in transit, or unauthorized repair or alternations. Further, the warranty does not cover natural disasters, such as fire, flood, hurricanes and tornadoes. This warranty gives you specific legal rights, and you may also have other rights that vary from country to country, state to state, province to province or jurisdiction to jurisdiction.

To get Warranty Service make sure you keep your sales receipt or document showing proof of purchase. Call (+1) 800-638-3722 or (+1) 708-377-0600 to receive a return authorization (RA) number, which must be included on the return label. Attach your proof of purchase to your defective product along with your name, address, daytime telephone number and description of the problem. Carefully package the product and send with shipping and insurance prepaid to:

Pelstar, LLC
Attention R/A# _____
Return Department
9500 West 55th Street
McCook, IL 60525



PELSTAR, LLC

9500 West 55th Street • McCook, IL 60525 • USA

1-800-638-3722 or 1-708-377-0600

PLEASE REGISTER YOUR SCALE FOR WARRANTY COVERAGE AT: <http://www.homscales.com>

Health o meter® is a registered trademark of Sunbeam Products, Inc. used under license.

Health o meter® Professional products are manufactured, designed, and owned by Pelstar, LLC.

We reserve the right to improve, enhance, or modify Health o meter® Professional product features or specifications without notice.

© Pelstar, LLC 2016

